

1

GL90-16

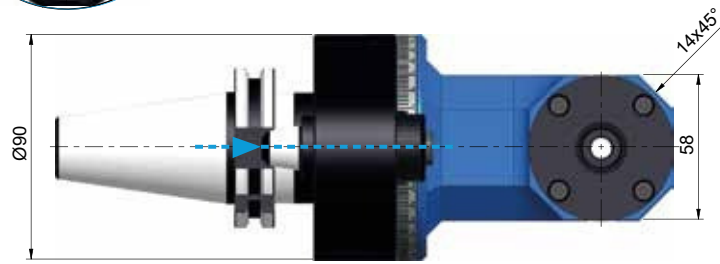

Technical data

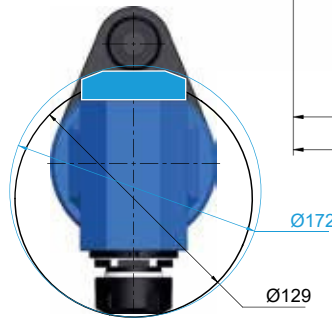
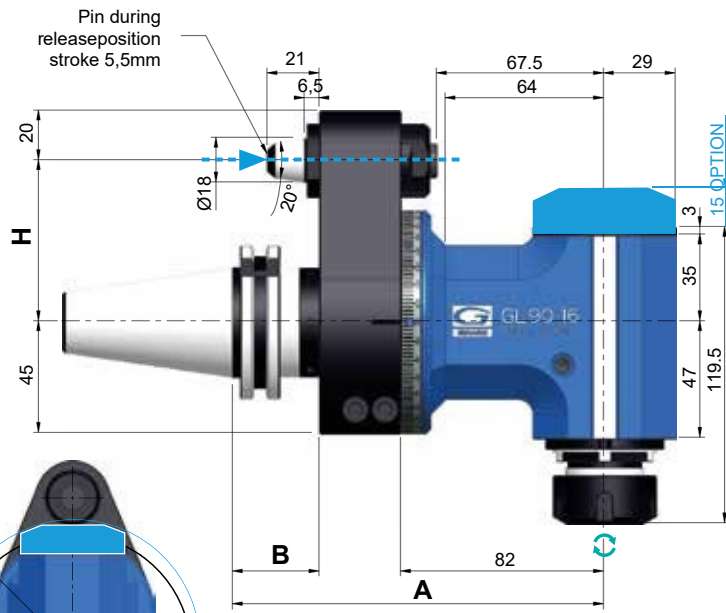

Ratio
1:1



ISO / BT 40
Kg 4,3
ISO / BT 50
Kg 7,2



Rpm
8.000



Ø 16



N 510



M 12



Nm 24



ER25
Ø1/16



Direction of rotation Same as the machine spindle

Coni - Shanks	SK DIN 69871		CAT ANSI B5.50		BT MAS 403		HSK DIN 69893			C. ISO 26623			
Size	40	50	40	50	40	50	63	80	100	C5	C6	C8	
Dual contact (Optional)													
H	Standard	65 / 80	80	65 / 80	80	65 / 80	80	65 / 80	65 / 80	80	65 / 80	65 / 80	80
	Optional 110												
A	150	150	150	150	150	156	157	157	160	153	153	155	
B	35	35	35	35	35	41	42	42	45	38	38	40	

PACK WEIGHT:

Bag 10,5Kg



STANDARD EQUIPMENT

Special bag / Stop block / ER nut / Wrenches / Grease tube / Instruction book

OPTIONS

COOLANT - Pin through Max 10bar - 4000Rpm - **Dry running YES**

COOLANT - Shank through Max 40bar - 4000Rpm - **Dry running NO**

OUTPUT -Shellmill holder Ø16

OUTPUT - ER32

DOUBLE OUTPUT - ER25 - ER 16M

OUTPUT -Weldon Max Ø16